

**EAST MIDLANDS GATEWAY  
RAIL FREIGHT INTERCHANGE**

**TRAFFIC MANAGEMENT**

**Planned Works and Night  
Closures Review**

- **W/C Mon 26<sup>th</sup> Mar 18**
- **W/C Mon 2nd April 18**
- **W/C Mon 9th April 18**
- **W/C Mon 16th April 18**



Updated Thurs 22<sup>nd</sup> March 18

# EAST MIDLANDS GATEWAY – W/C 26<sup>th</sup> March 18



Warren Lane  
Roundabout Narrow  
lanes 24/7.

Warren Lane Bridge  
Two way Lights

M1 Junc 24A Southbound exit Slip lane 2 closure 24/7  
Traffic to Warren Lane via A50 Junction 1

M1 Junc 24 Southbound Slip Hard Shoulder closure 24/7  
M1 Junc 24 Southbound Slip Lane 1 closure Daytime Off  
Peak 0930 -1530hrs

50MPH A50 N/B 24/7  
Jnc 24 to Main St

**Junc 24 Roundabout.**

Junction 24 - see Enlarged sheet

A453 Dual Carriageway Open .

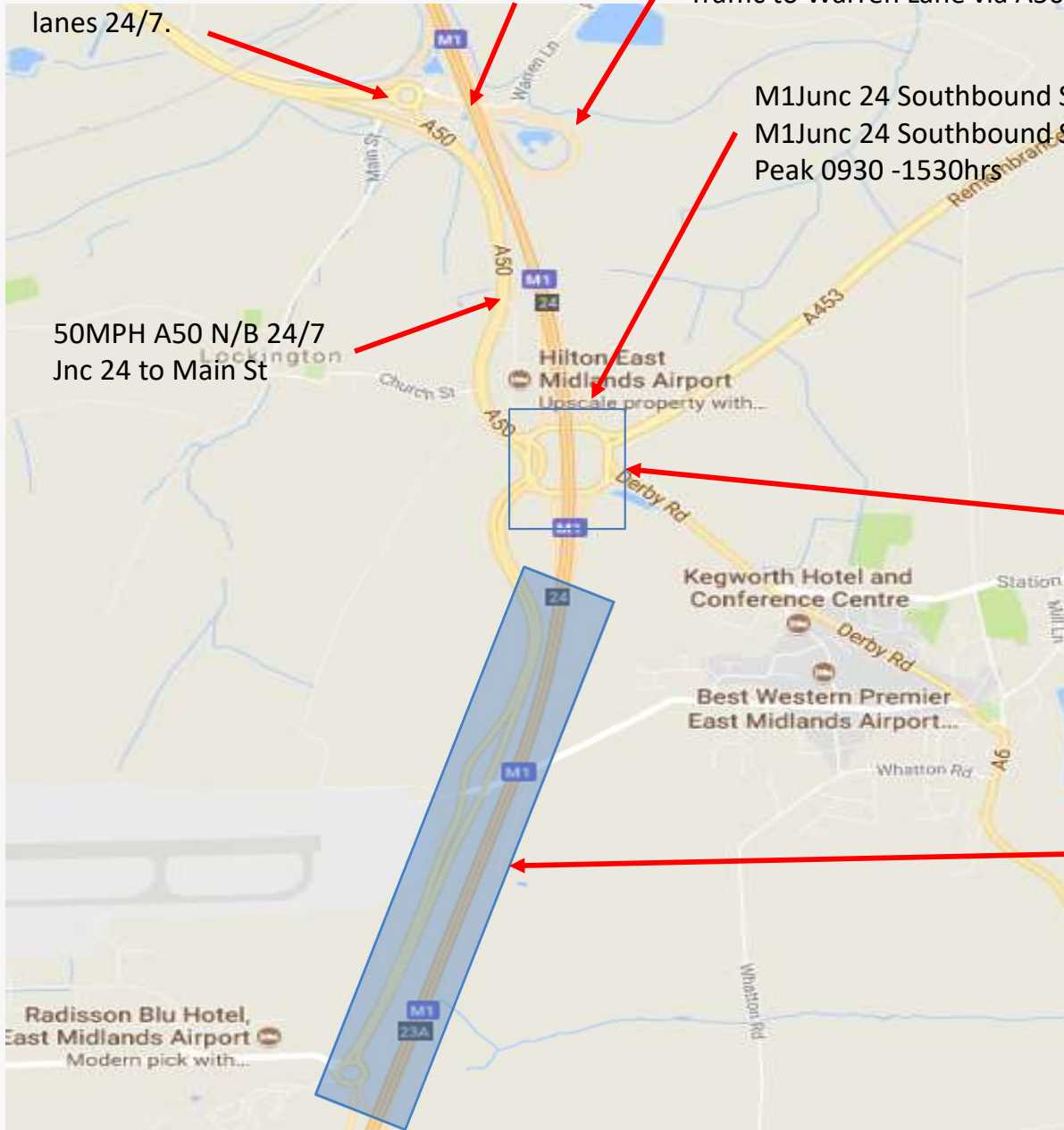

# Junction 24– W/C Mon 26<sup>th</sup> March 18

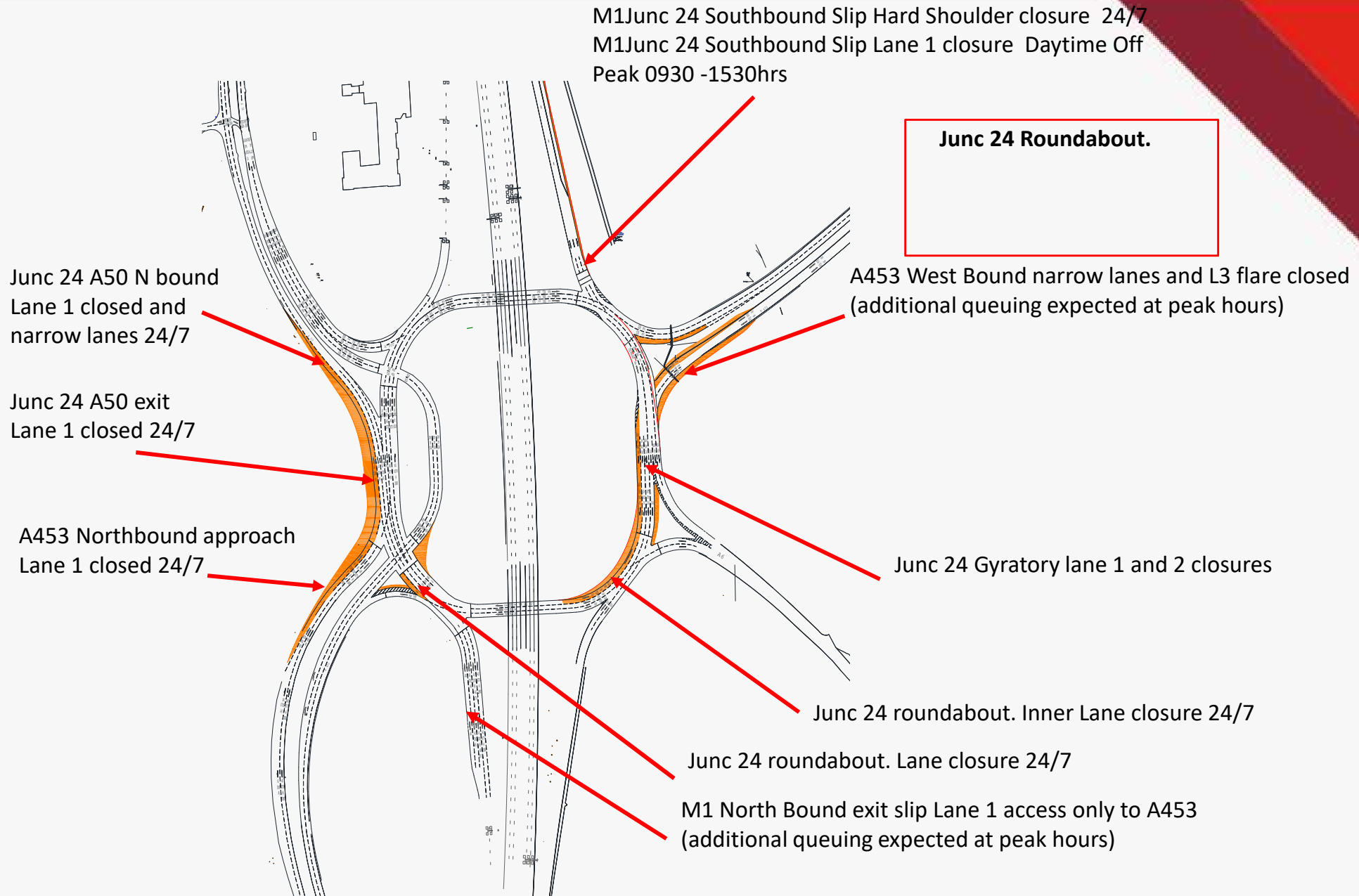

# EAST MIDLANDS GATEWAY – W/C 2nd April 18



Warren Lane  
Roundabout Narrow  
lanes 24/7.

Warren Lane Bridge  
Two way Lights

M1 Junc 24A Southbound exit Slip lane 2 closure 24/7  
Traffic to Warren Lane via A50 Junction 1

M1 Junc 24 Southbound Slip Hard Shoulder closure 24/7  
M1 Junc 24 Southbound Slip Lane 1 closure Daytime Off  
Peak 0930 -1530hrs

M1 Southbound off slip lane 1 closure 2100-0600.  
Tues 3<sup>rd</sup> April 4 nights

50MPH A50 N/B 24/7  
Jnc 24 to Main St

Junc 24 Roundabout.  
Various night time lane  
closures 3<sup>rd</sup> April – 6<sup>th</sup>  
April

Junction 24 - see Enlarged sheet

A453 Dual Carriageway Open .  
A453 North and South Bound Lane closures 2100-0600  
Tues 3<sup>rd</sup> April 4 nights



# Junction 24– W/C Mon 2nd April 18

M1Junc 24 Southbound Slip Hard Shoulder closure 24/7  
M1Junc 24 Southbound Slip Lane 1 closure Daytime Off  
Peak 0930 -1530hrs  
M1 Southbound off slip lane 1 closure 2100-0600.  
(TSM to extend SMT lane closure) Tues 3<sup>rd</sup> April 4 nights

**Junc 24 Roundabout.**  
**Various night time lane**  
**closures 3<sup>rd</sup> – 6<sup>th</sup> April**

Junc 24 A50 N bound  
Lane 1 closed and  
narrow lanes 24/7

Junc 24 A50 exit  
Lane 1 closed 24/7

A453 Northbound approach  
Lane 1 closed 24/7

A453 West Bound narrow lanes and L3 flare closed  
(additional queuing expected at peak hours)

Junc 24 Gyratory lane 1 and 2 closures

Junc 24 roundabout. Inner Lane closure 24/7

Junc 24 roundabout. Lane closure 24/7

M1 North Bound exit slip Lane 1 access only to A453  
(additional queuing expected at peak hours)

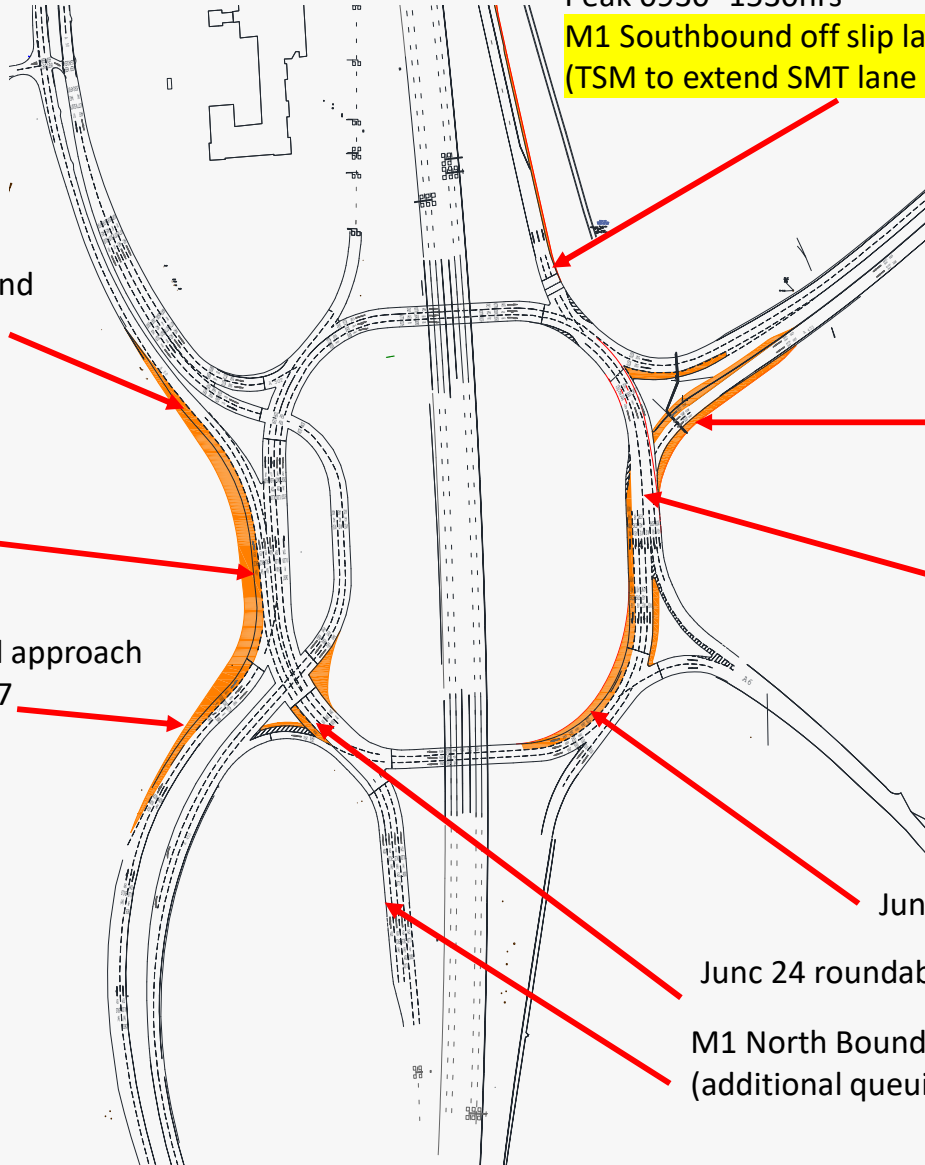



# EAST MIDLANDS GATEWAY – W/C Mon 9<sup>th</sup> April 18



Warren Lane  
Roundabout Narrow  
lanes 24/7.

Warren Lane Bridge  
Two way Lights

M1 Junc 24A Southbound exit Slip lane 2 closure 24/7  
Traffic to Warren Lane via A50 Junction 1

**M1 Junc 24A SB Closed Mon 9<sup>th</sup> April 5 nights 2100-0600**

M1 Junc 24 Southbound Slip Hard Shoulder closure 24/7  
M1 Junc 24 Southbound Slip Lane 1 closure Daytime Off  
Peak 0930 -1530hrs

Main St Closed  
(Diversion via Castle  
Donnington)

50MPH A50 N/B 24/7  
Jnc 24 to Main St

**Junc 24 Roundabout.  
Various night time lane  
closures 9-13<sup>th</sup> April**

Junction 24 - see Enlarged sheet

A453 Dual Carriageway Open .  
**A453 North and South Bound Lane closures 2100-0600  
Mon 9<sup>th</sup> April 5 nights**



# Junction 24– W/C Mon 9<sup>th</sup> April 18

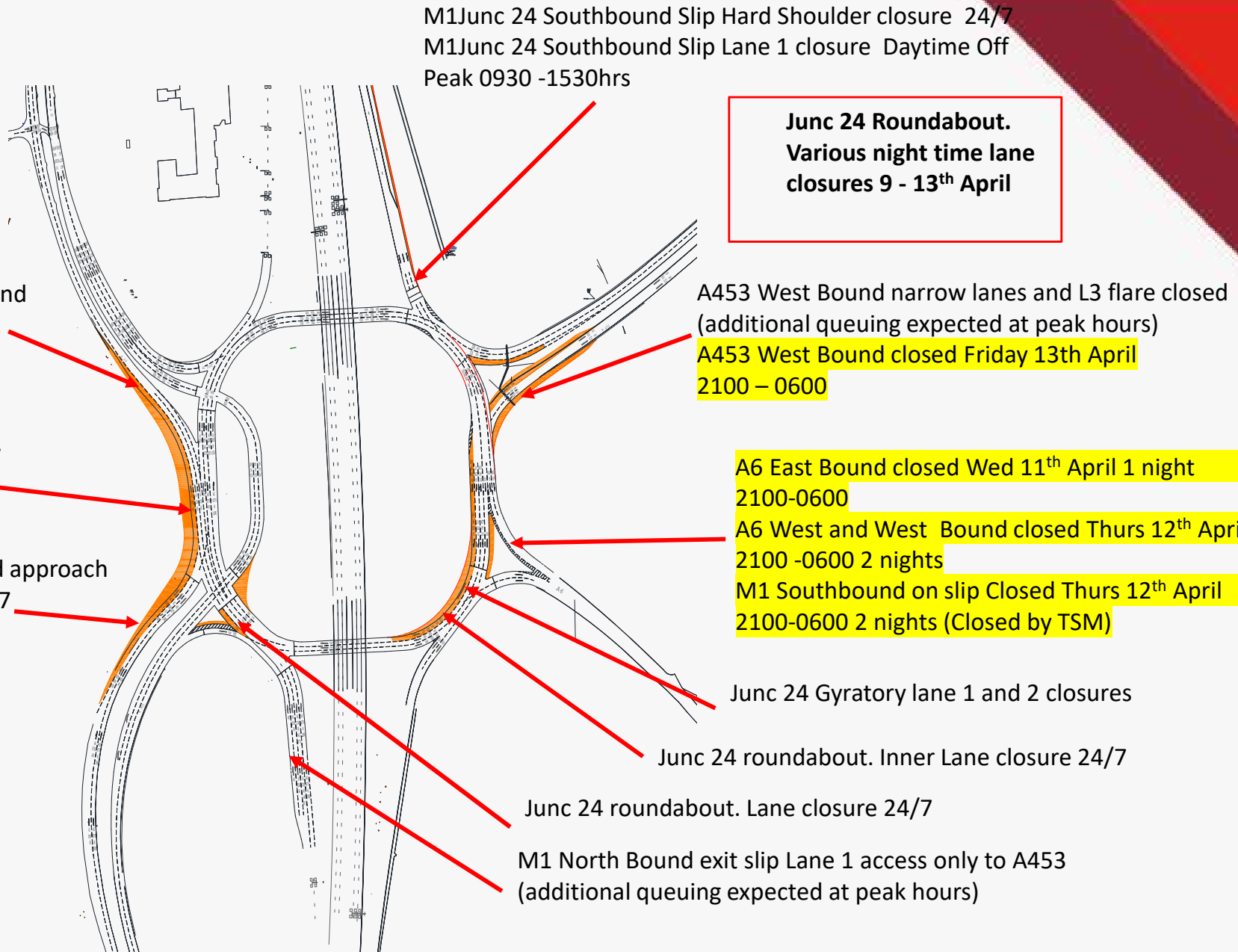

M1Junc 24 Southbound Slip Hard Shoulder closure 24/7  
M1Junc 24 Southbound Slip Lane 1 closure Daytime Off  
Peak 0930 -1530hrs

**Junc 24 Roundabout.  
Various night time lane  
closures 9 - 13<sup>th</sup> April**

Junc 24 A50 N bound  
Lane 1 closed and  
narrow lanes 24/7

A453 West Bound narrow lanes and L3 flare closed  
(additional queuing expected at peak hours)  
A453 West Bound closed Friday 13<sup>th</sup> April  
2100 – 0600

Junc 24 A50 exit  
Lane 1 closed 24/7

A6 East Bound closed Wed 11<sup>th</sup> April 1 night  
2100-0600

A453 Northbound approach  
Lane 1 closed 24/7

A6 West and West Bound closed Thurs 12<sup>th</sup> April  
2100 -0600 2 nights

M1 Southbound on slip Closed Thurs 12<sup>th</sup> April  
2100-0600 2 nights (Closed by TSM)

Junc 24 Gyratory lane 1 and 2 closures

Junc 24 roundabout. Inner Lane closure 24/7

Junc 24 roundabout. Lane closure 24/7

M1 North Bound exit slip Lane 1 access only to A453  
(additional queuing expected at peak hours)

# EAST MIDLANDS GATEWAY – W/C Mon 16<sup>th</sup> April 18



Warren Lane  
Roundabout Narrow  
lanes 24/7.

Warren Lane Bridge  
Two way Lights

M1 Junc 24A Southbound exit Slip lane 2 closure 24/7  
Traffic to Warren Lane via A50 Junction 1

M1 Junc 24 Southbound Slip Hard Shoulder closure 24/7  
M1 Junc 24 Southbound Slip Lane 1 closure Daytime Off  
Peak 0930 -1530hrs

Main St Closed  
(Diversion via Castle  
Donnington)

50MPH A50 N/B 24/7  
Jnc 24 to Main St

**Junc 24 Roundabout.  
Various night time lane  
closures 16-20<sup>th</sup> April**

Junction 24 - see Enlarged sheet

A453 Dual Carriageway Open .  
A453 North and South Bound Lane closures 2100-0600  
Mon 16<sup>th</sup> April 5 nights

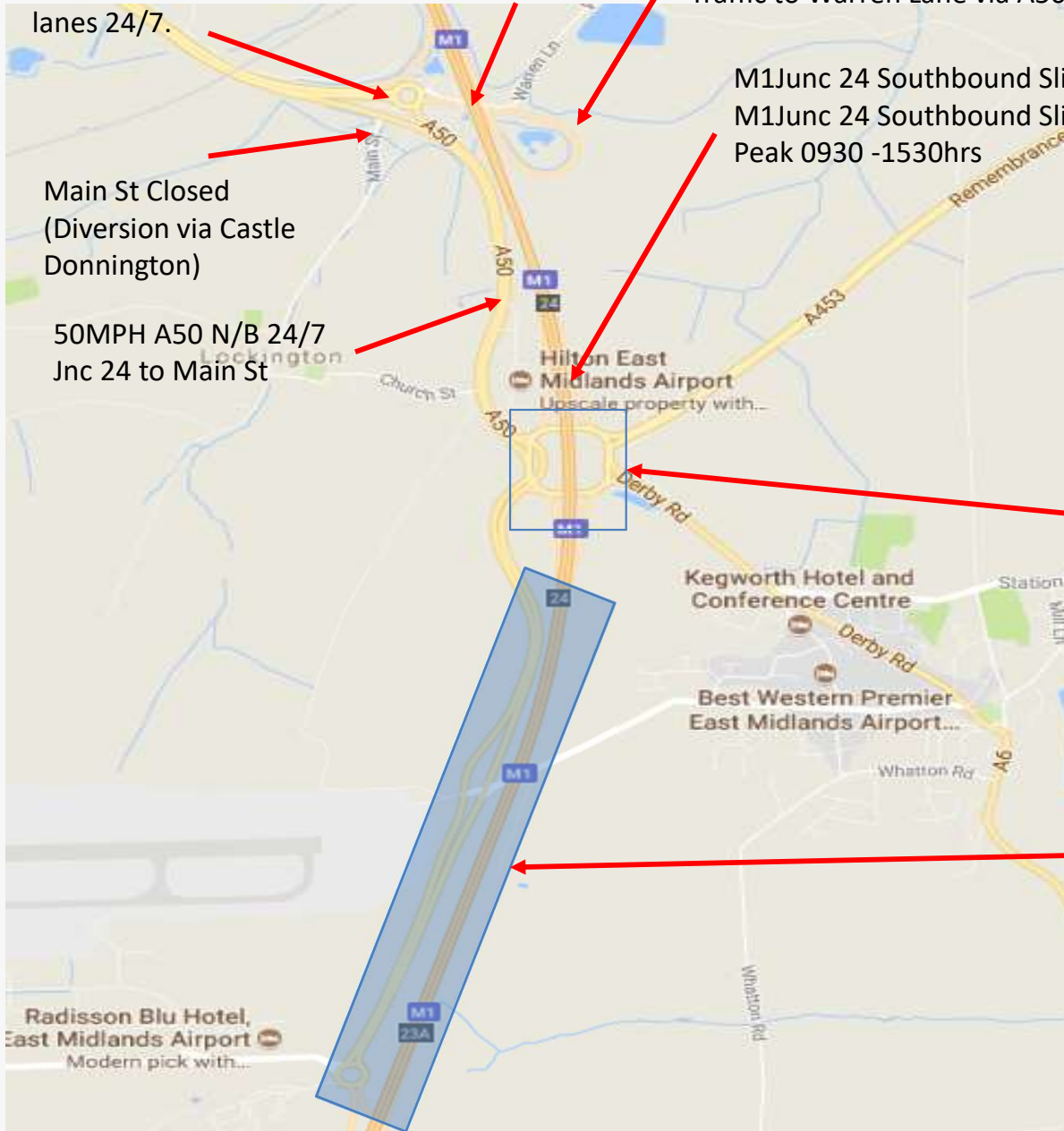



# Junction 24– W/C Mon 16<sup>th</sup> April 18

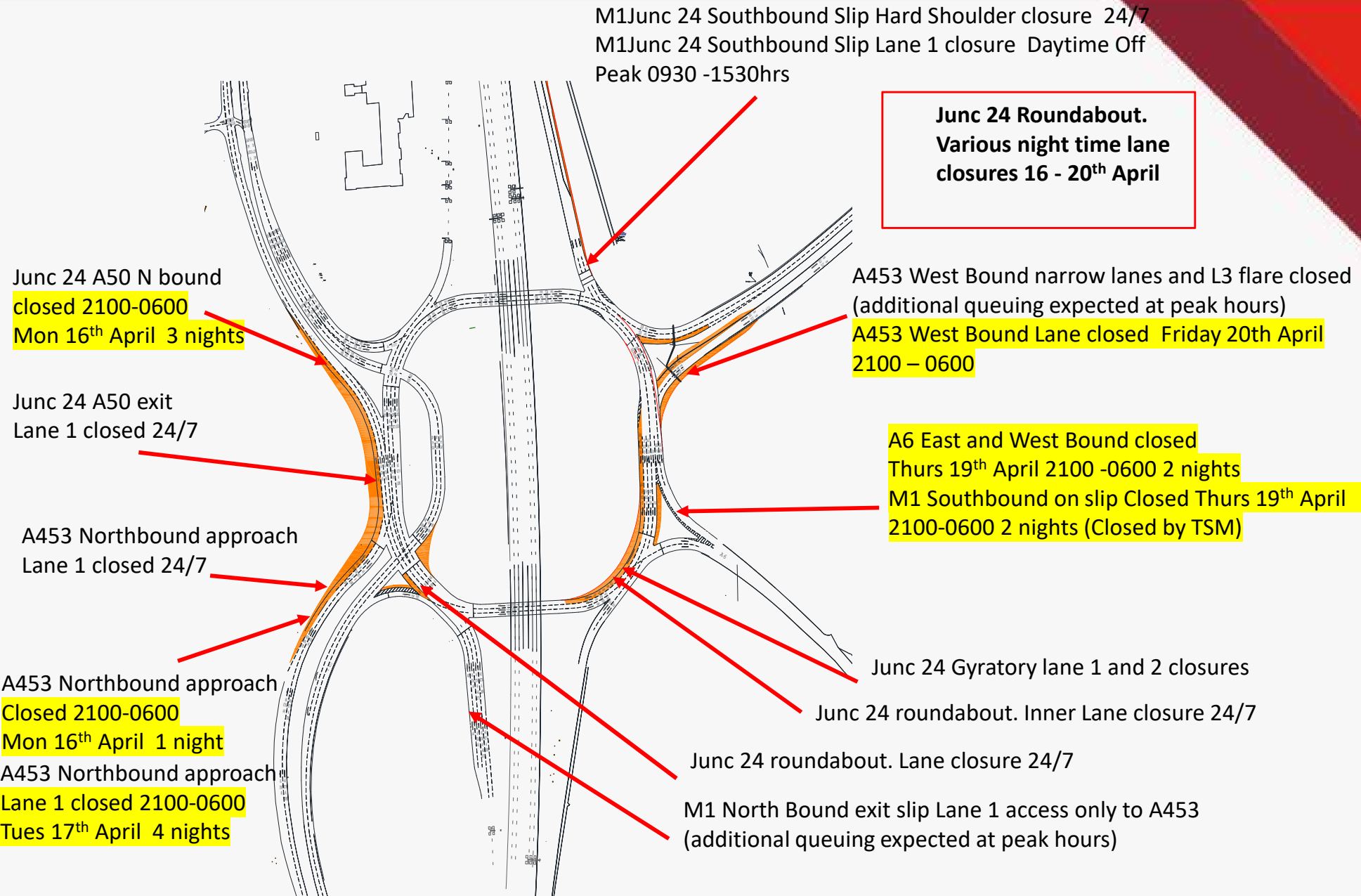

# EAST MIDLANDS GATEWAY Main street Footpath and Cycle Path Closures– From 26<sup>th</sup> Feb 18

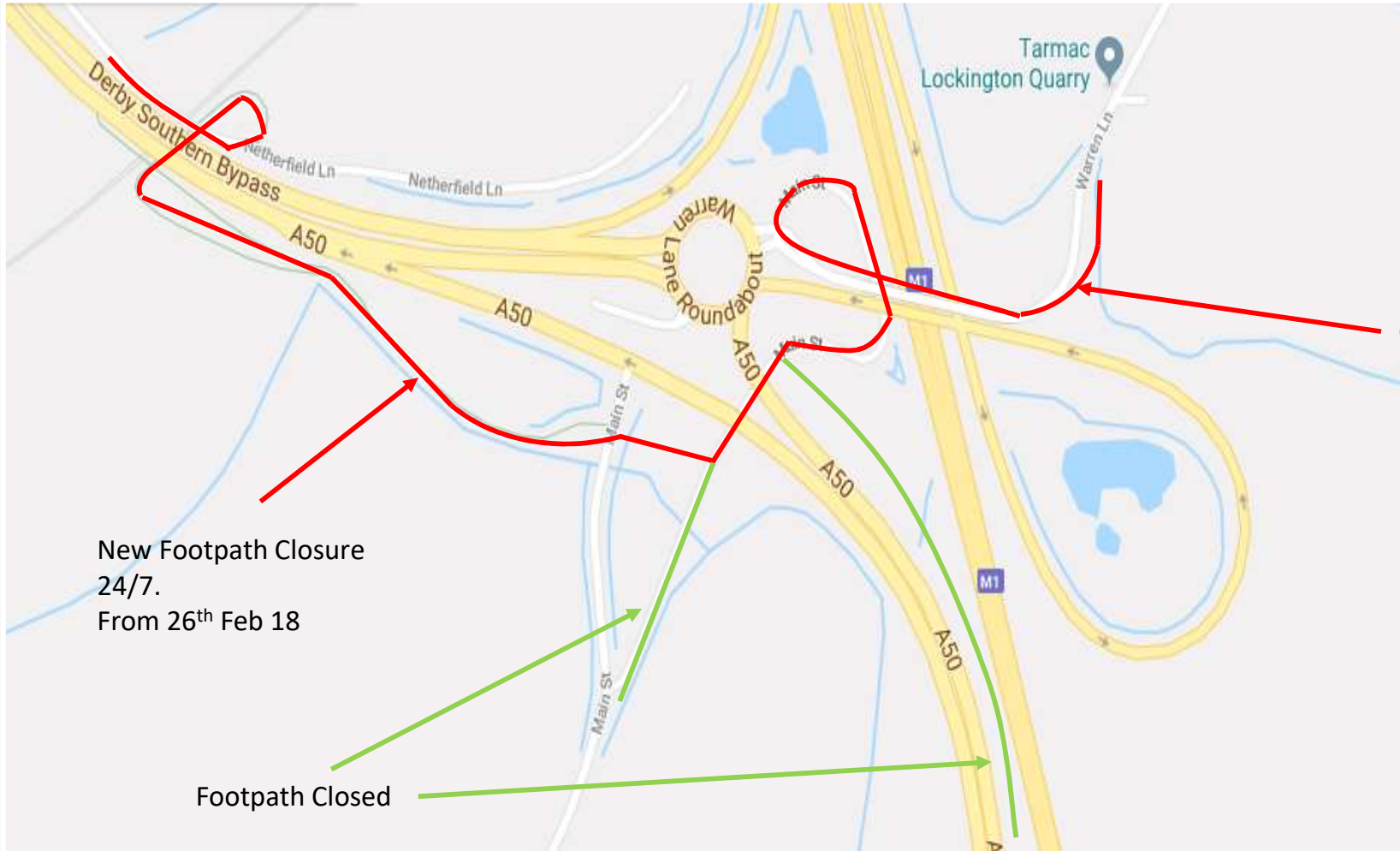

New Footpath Closures From 26<sup>th</sup> Feb 18 24/7

New Footpath Closure 24/7. From 26<sup>th</sup> Feb 18

Footpath Closed

# EAST MIDLANDS GATEWAY Main street Road Closures From 26<sup>th</sup> Feb 18

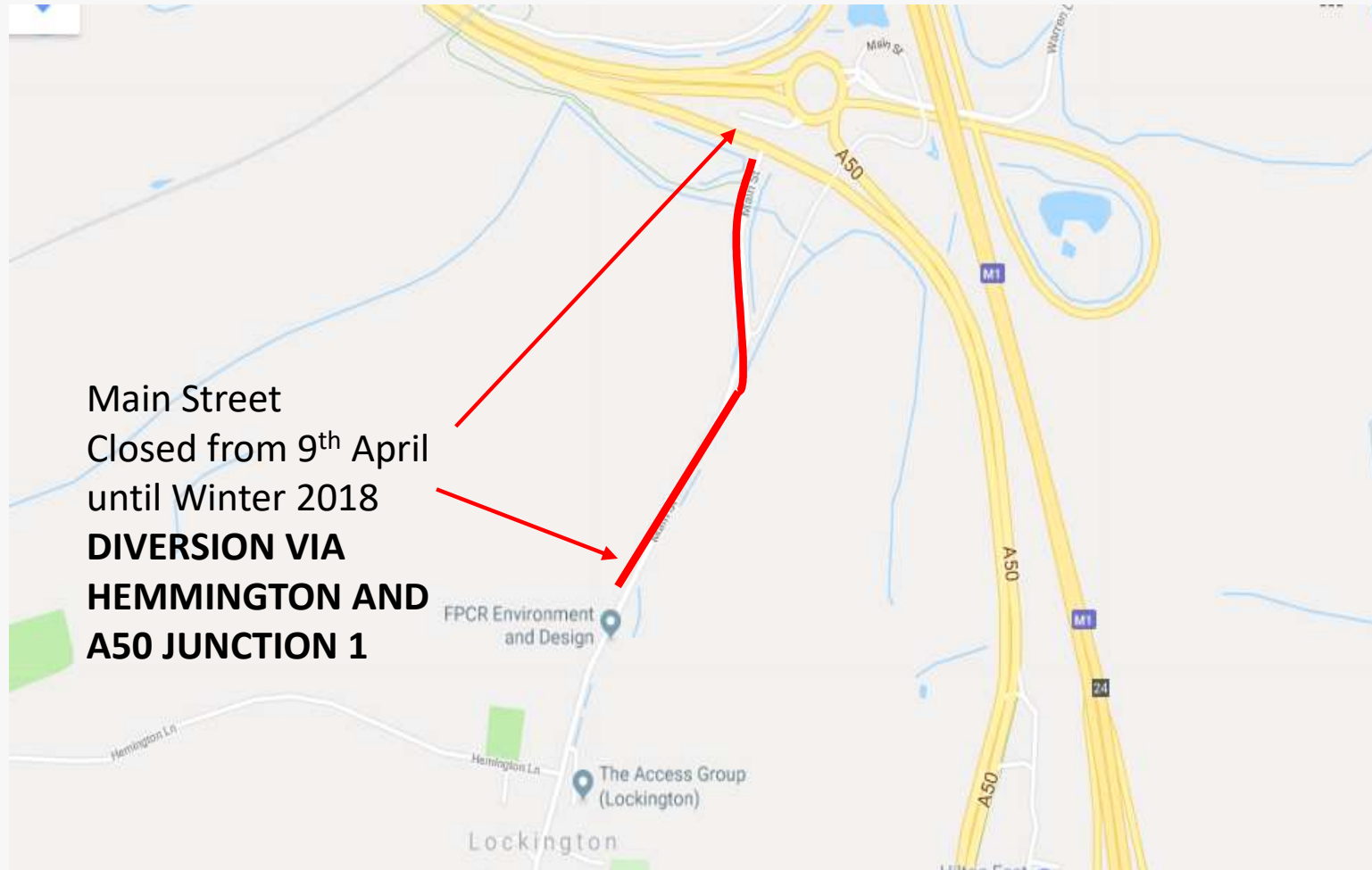

# Further Information

## Contacts,

Tel EMG Enquiries  
- 07514227681

E-mail  
- [emg-enquiries@winvic.co.uk](mailto:emg-enquiries@winvic.co.uk)

Web East Midlands Gateway specific  
- [www.slp-emg.com](http://www.slp-emg.com)

Web on the day of travel  
- [www.roadworks.org/](http://www.roadworks.org/)  
- [www.trafficengland.com/](http://www.trafficengland.com/)

## Project updates,

A project update if you wish to be added please e-mail request to above address.

This will include an overall project update and detailed traffic management plans for the forthcoming weeks including dates and times.

Please note all dates within this document are to be confirmed closer to the time