

EAST MIDLANDS GATEWAY
RAIL FREIGHT INTERCHANGE

TRAFFIC MANAGEMENT

**Planned Works and Night
Closures Review**

- **W/C Mon 20th Nov 17**
- **W/C Mon 27th Nov 17**
- **W/C Mon 4th Dec 17**



Updated Tuesday 15th Nov 17

EAST MIDLANDS GATEWAY – W/C 20th Nov Oct 17



M1 Junc 24a Southbound exit Slip lane 2 closure 24/7

Warren Lane Bridge
Two way Lights

50MPH A50 N/B 24/7
Jnc 24 to Main St

M1 Junc 24 Southbound Slip Hard Shoulder closure 24/7
M1 Junc 24 Southbound Slip Lane 1 closure Daytime Off
Peak 0930 -1530hrs

**Junc 24 Roundabout.
Various night time lane
closures 20th – 25th Nov**

Junction 24 - see Enlarged sheet

50 MPH on A453 jnc24
to Finger farm rd-ab.

A453 Dual Carriageway Open daytime .
Ashby Road Closed
North Bound Night closures Mon 20th – Friday 24th
Nov 2100 – 0600
South Bound Lane 2 open only Mon 20th – Friday 24th
Nov 2100 – 0600



Junction 24– W/C Mon 20th Nov 17

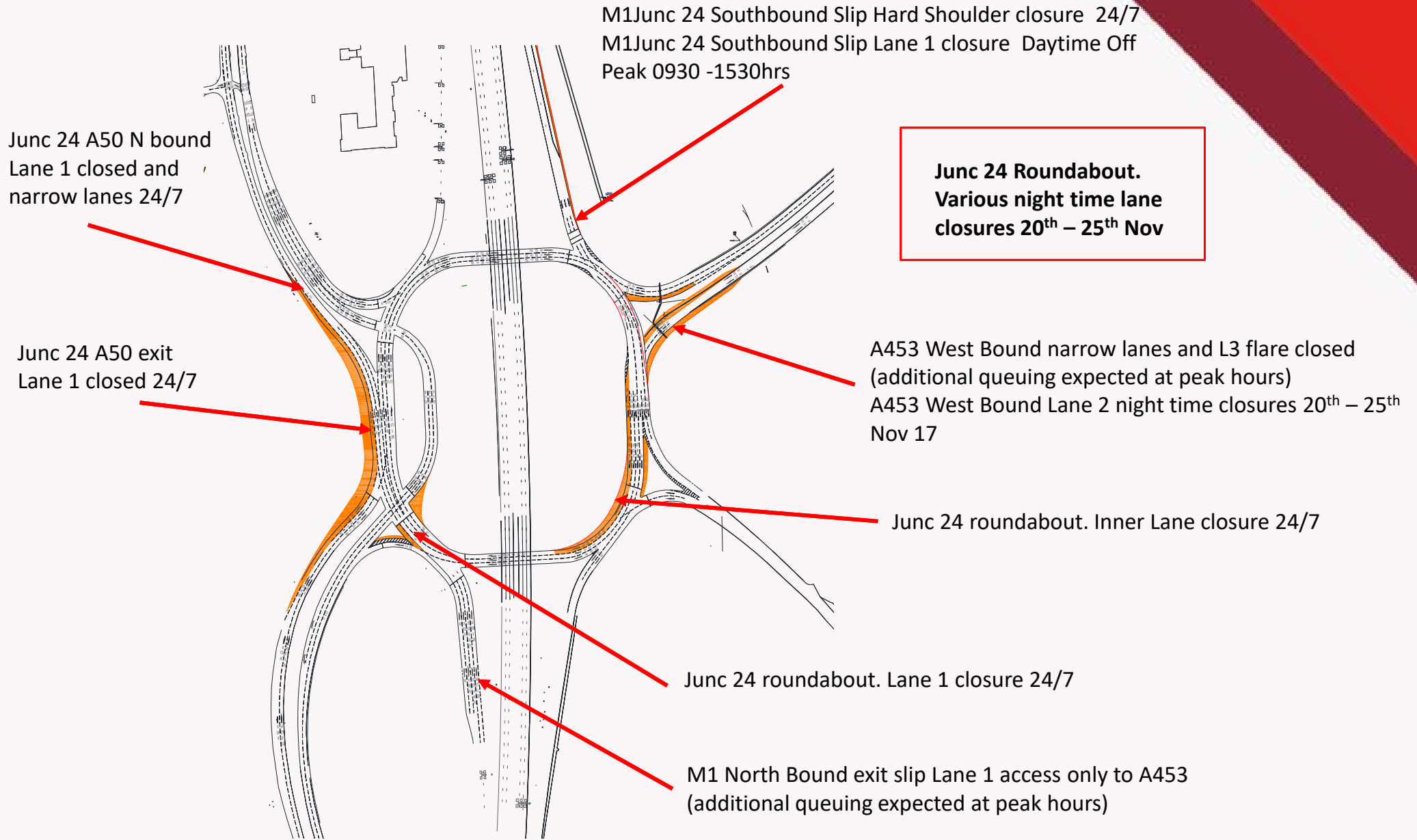

EAST MIDLANDS GATEWAY – W/C 27th Nov Oct 17



M1 Junc 24a Southbound exit Slip lane 2 closure 24/7

Warren Lane Bridge
Two way Lights

50MPH A50 N/B 24/7
Jnc 24 to Main St

M1 Junc 24 Southbound Slip Hard Shoulder closure 24/7
M1 Junc 24 Southbound Slip Lane 1 closure Daytime Off
Peak 0930 -1530hrs

**Junc 24 Roundabout.
Various night time lane
closures 27th – 1st Dec**

Junction 24 - see Enlarged sheet

50 MPH on A453 jnc24
to Finger farm rd-ab.

A453 Dual Carriageway Open daytime .
Ashby Road Closed
Night time closure Mon 27th Nov 17 2100 - 0600
Lane closures 28th – 30th Nov 17 2100 - 0600

Radisson Blu Hotel,
East Midlands Airport
Modern pick with...



Junction 24– W/C Mon 27th Nov 17

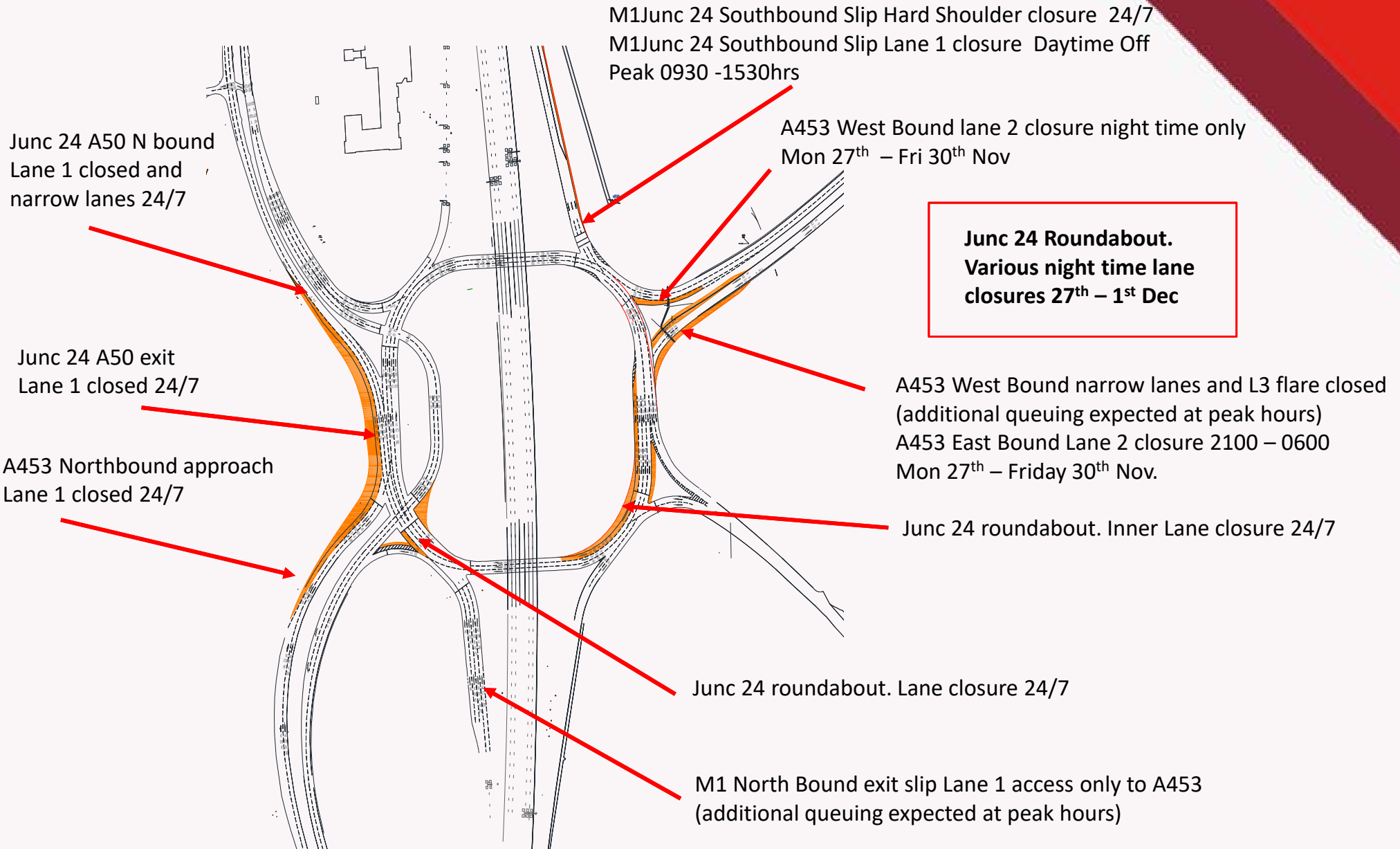

EAST MIDLANDS GATEWAY – W/C 4th Dec 17



M1 Junc 24a Southbound exit Slip lane 2 closure 24/7

Warren Lane Bridge
Two way Lights

50MPH A50 N/B 24/7
Jnc 24 to Main St

M1 Junc 24 Southbound Slip Hard Shoulder closure 24/7
M1 Junc 24 Southbound Slip Lane 1 closure Daytime Off
Peak 0930 -1530hrs

Junc 24 Roundabout.
Various night time lane
closures 4th – 9th Dec

Junction 24 - see Enlarged sheet

50 MPH on A453 jnc24
to Finger farm rd-ab.

A453 Dual Carriageway Open daytime .
Night closures 4th – 9th Dec 2100 - 0600

Radisson Blu Hotel,
East Midlands Airport
Modern pick with...



Junction 24– W/C Mon 4th Dec 17

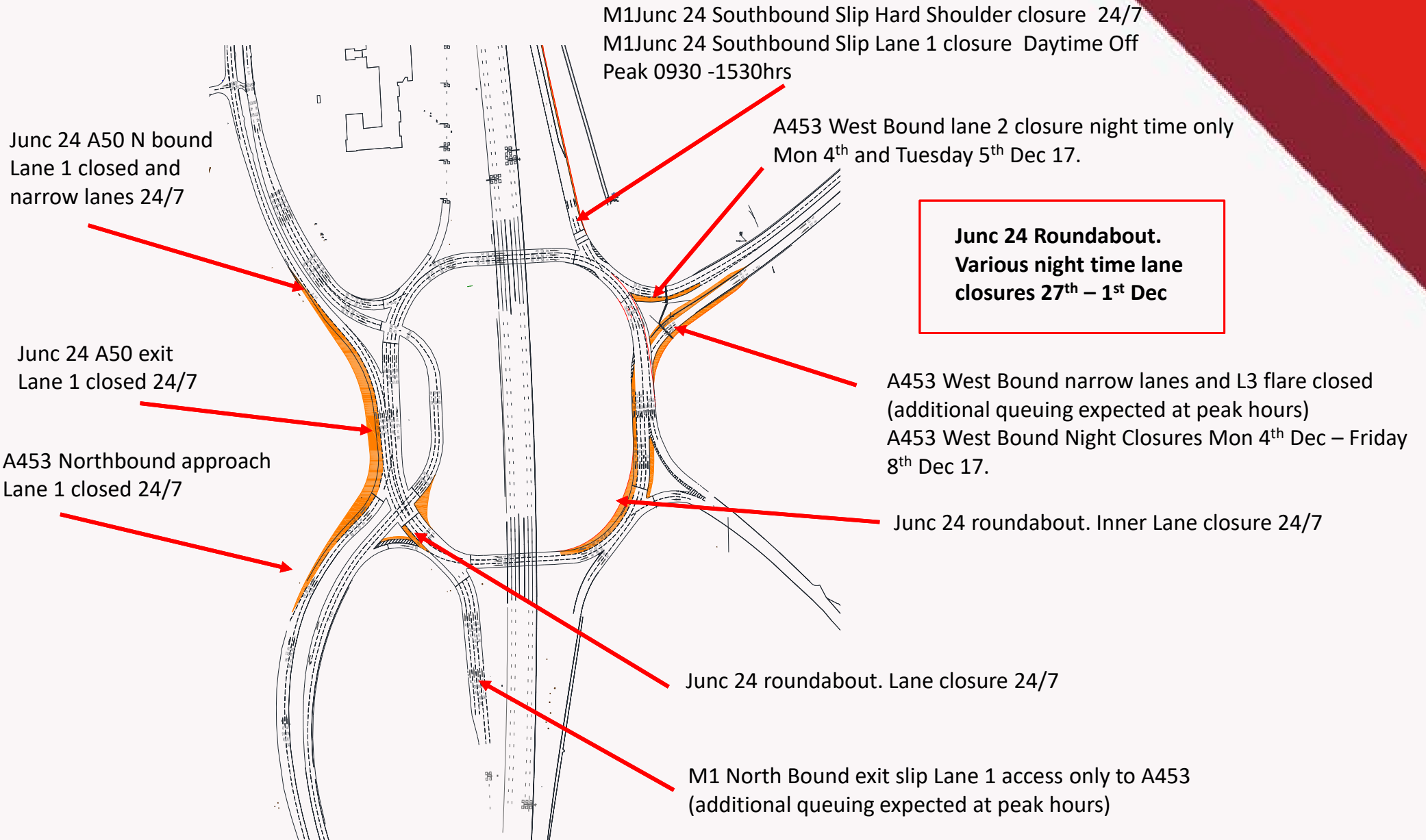

Further Information

Contacts,

Tel EMG Enquiries
- 07514227681

E-mail
- emg-enquiries@winvic.co.uk

Web East Midlands Gateway specific
- www.eastmidlandsgateway.co.uk/community/travel.php

Web on the day of travel
- www.roadworks.org/
- www.trafficengland.com/

Project updates,

A project update if you wish to be added please e-mail request to above address.

This will include an overall project update and detailed traffic management plans for the forthcoming weeks including dates and times.

Please note all dates within this document are to be confirmed closer to the time